

PMxx

Permanent Link Module

*for the DSP/OMNI-LIA101
Permanent Link Adapter*

Instruction Sheet

The PMxx Permanent Link Module makes a DSP/OMNI-LIA101 Permanent Link Adapter electrically compatible with a particular manufacturer's jack.

Refer to the PMxx module list included for applications for this module and other available modules. For the most recent list of available modules, visit the Fluke Networks website at www.flukenetworks.com.

PN 1611107 (English) April 2001, Rev. 2, 1/02

© 2001, 2002 Fluke Networks, Inc. All rights reserved. Printed in USA.

All product names are trademarks of their respective companies.

Handling Information



To avoid latent or immediate damage due to electrostatic discharge:

- **Before handling a module or an adapter with no module attached, ground yourself when possible by touching a grounded, conductive surface.**
- **Always remove the adapter from the test tool before changing the personality module.**
- **Always keep a personality module attached to the adapter cable.**
- **Always store the personality module in its original, static protection bag when not in use.**

Installation

Attach the module to a DSP/OMNI-LIA101 adapter cable as follows (refer to Figure 1):

1. Ground yourself by touching a grounded, conductive surface.
2. Remove the link interface adapter from the test tool.
3. Use your fingers to unscrew the screw on the personality module. If necessary, you can use a flat-blade screwdriver to loosen the screw.
4. Remove the module; then store it in its original, static protection bag.
5. Put the new module in place and tighten the screw with your fingers.

Caution

Tighten the screw with your fingers only. Do not overtighten. Doing so can damage the module or the end of the cable.

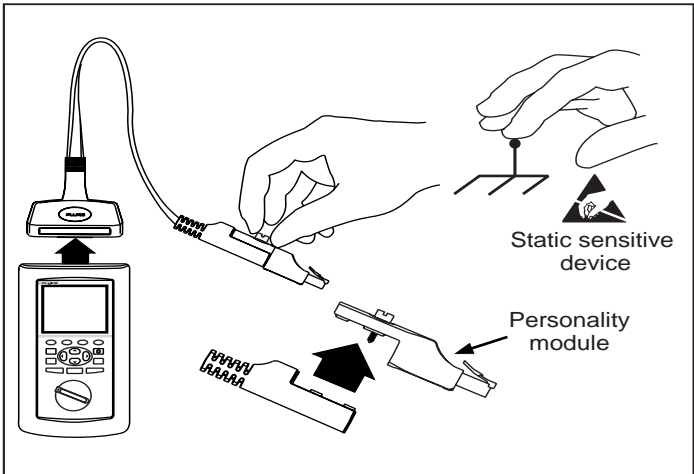

aen01f.eps

Figure 1. Replacing the Personality Module

Maintenance

Always store the module in its original, static protection bag when not in use.

Clean the module case with a soft cloth dampened with water or water and a mild soap. Do not use abrasives, solvents, or alcohol.

Contacting Fluke Networks

Visit the Fluke Networks website at www.flukenetworks.com.
Send email to fluke-assist@flukenetworks.com.

To order accessories or get the location of the nearest Fluke Networks distributor or service center, call:

- USA: 1-888-993-5853
- Canada: 1-800-363-5853
- Europe: +31-402-678-200
- Japan: +81-3-3434-0181
- Singapore: +65-738-5655
- Anywhere in the world: +1-425-446-4519

For operating assistance in the USA, call 1-800-283-5853.

Specifications

Refer to the PMxx module list included for applications for this module. Module information is also posted on the Fluke Networks website at www.flukenetworks.com.

LIMITED WARRANTY AND LIMITATION OF LIABILITY

This Fluke Networks product will be free from defects at the time of purchase. This warranty does not cover damage from accident, neglect, misuse, alteration, contamination, or abnormal conditions of operation or handling. Resellers are not authorized to extend any other warranty on Fluke Networks' behalf. To obtain service during the warranty period, contact your nearest Fluke Networks authorized service center to obtain return authorization information.

Fluke Networks' warranty obligation is limited, at Fluke Networks' option, to refund of the purchase price, or free of charge repair or replacement of a defective product that is returned to an authorized Fluke Networks Service Center within the warranty period.

Warranty service is available outside the United States only if product was purchased through a Fluke Networks Authorized Sales Outlet in the country of use or the applicable Fluke Networks international price was paid.

THIS WARRANTY IS YOUR ONLY REMEDY. NO OTHER WARRANTIES, SUCH AS FITNESS FOR A PARTICULAR PURPOSE, ARE EXPRESSED OR IMPLIED. FLUKE NETWORKS IS NOT LIABLE FOR ANY SPECIAL, INDIRECT, INCIDENTAL OR CONSEQUENTIAL DAMAGES OR LOSSES, ARISING FROM ANY CAUSE OR THEORY. Since some states or countries do not allow the exclusion or limitation of an implied warranty or of incidental or consequential damages, this limitation of liability may not apply to you.

Fluke Networks, Inc.
P.O. Box 9090
Everett, WA 98206-9090
U.S.A.

Fluke Europe B.V.
P.O. Box 1186
5602 BD Eindhoven
The Netherlands